

35011 POLISHED IMPERFECT DESK - MAHOGANY
ASSEMBLY INSTRUCTIONS FOR DESK INSTALLATION

HARDWARE ENCLOSED

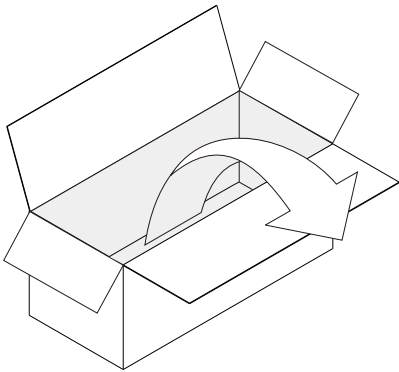

TOOL

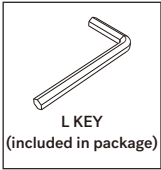

IN YOUR PACKAGE :

ASSEMBLY INSTRUCTION
HARDWARES (AS LISTED ABOVE)

PARTS TO BE INSTALLED

- 1. TABLE TOP 1 pc
- 2. LEGS 3 pcs

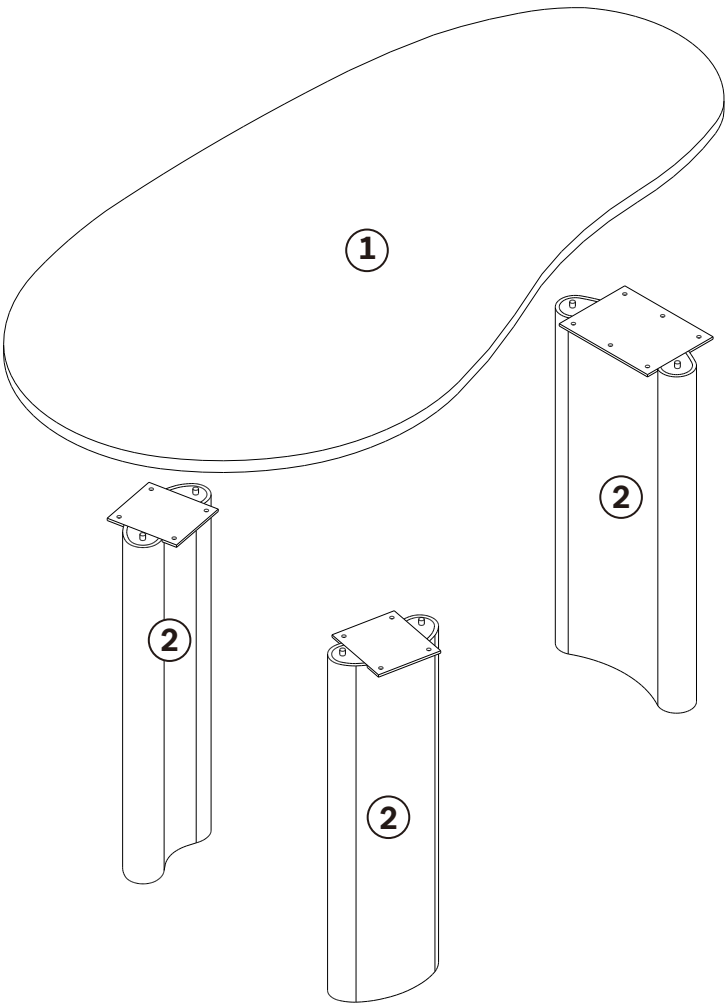

SYMBOLS



DIRECTION

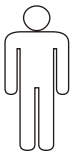

NUMBER OF
PERSONS NEEDED



USE HAND

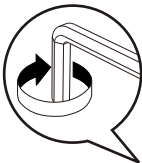

USE L KEY
TO TIGHTEN

NOTICE

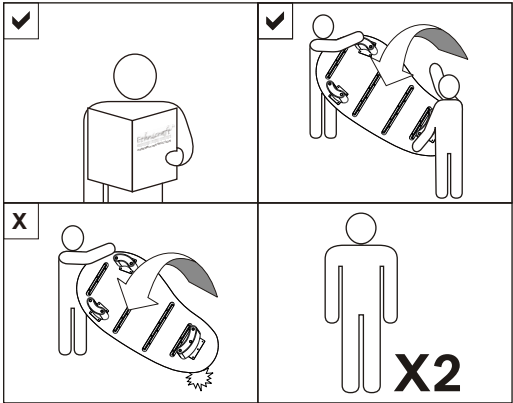

35011 POLISHED IMPERFECT DESK - MAHOGANY ASSEMBLY INSTRUCTIONS FOR DESK INSTALLATION

A INSTALLING LEGS TO TABLE TOP

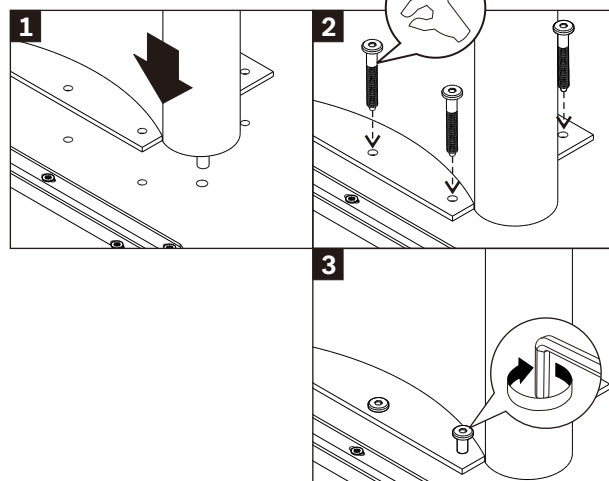
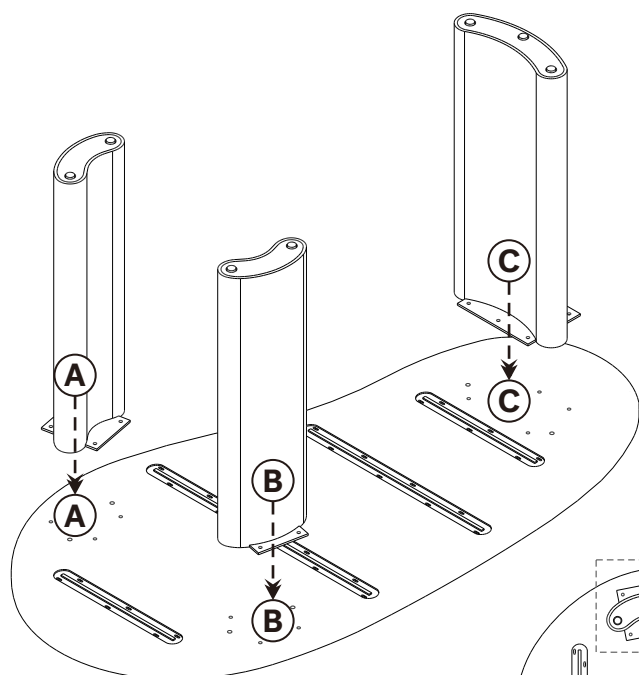

- ! - USE JCBC SCREW M6x20 (14X)
- TIGHTEN FULLY

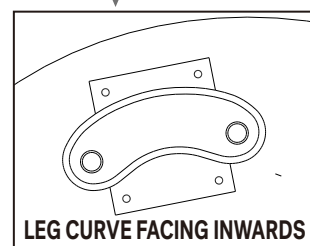
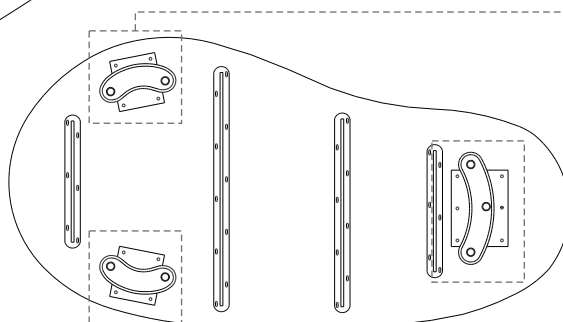

LEG CURVE FACING INWARDS

B ADJUSTING RUBBER PAD

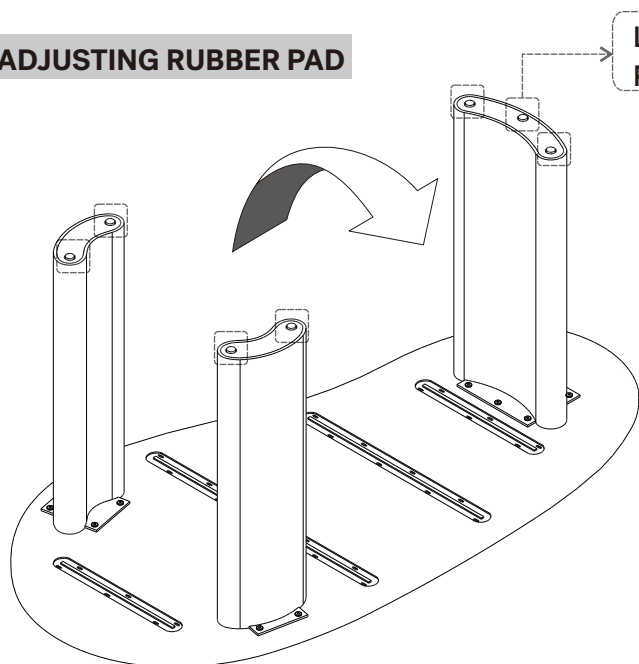

LEVELER / RUBBER PADS
POSITION

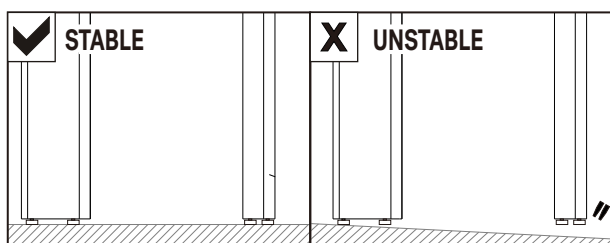
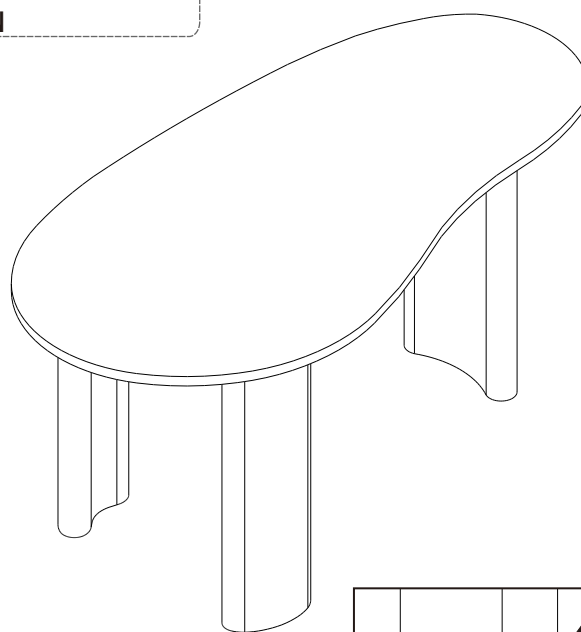

NOTE :
THIS IS A COMPULSORY ACTION TO MAKE SURE
ALL OF THE RUBBER PADS TOUCH THE GROUND!

